

The volume discount rate is also applicable to alteration cost.  
All price & lead time are to be quoted.

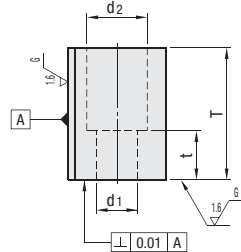

RoHS

## Holder

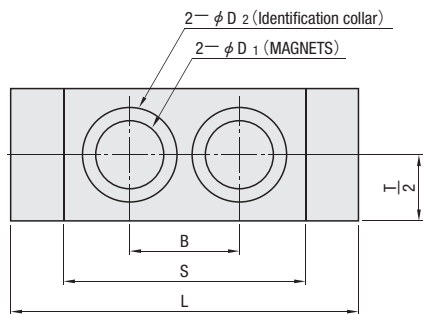
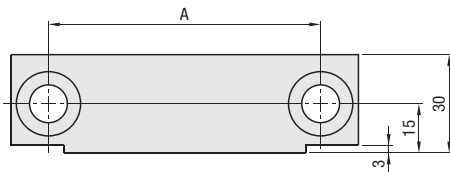

**M** SS400  
MLK40 • 100 Neodymium magnet (Heat resistance : up to 80°C)  
MLK80 • 200 SmCo magnet (Rare earth) (Heat resistance : up to 200°C)

## Block

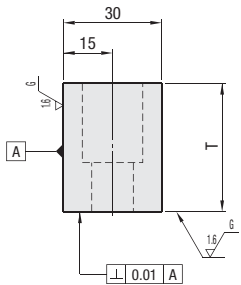
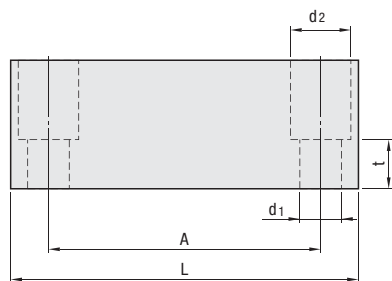

**M** SS400

Catalog No.	Adhesion strength (per set under 20°C)	A	B	S	L	T	t	D <sub>1</sub>	D <sub>2</sub>	Identification collar	d <sub>1</sub>	d <sub>2</sub>	A
<b>MLK 40</b>	392.3N {40kgf}	63	25	60	80	25	12	18	22	Gold (Brass)	9	14	CB8—25 4 pcs.
<b>MLK 80</b>	784.5N {80kgf}									Silver (Aluminum)			Spring washers 4 pcs.
<b>MLK100</b>	980.7N {100kgf}	100	39	79	126	40	15	30	34	Gold (Brass)	11	18	CB10—30 4 pcs.
<b>MLK200</b>	1961.3N {200kgf}									Silver (Aluminum)			Spring washers 4 pcs.

Adhesion strength per set indicates the vertical force by which a holder and a block adhered each other can be separated.



Order

Catalog No.  
**MLK100**



Delivery

SGP Stock

For area out of Singapore please refer to P.i.

## Quantity discount rate

Quantity	1~9	10~19	20~49	50~100
Rate	—	5%	10%	15%

Catalog No.	U/Price 1~9 sets
<b>MLK 40</b>	<b>Quotation</b>
<b>MLK 80</b>	
<b>MLK100</b>	
<b>MLK200</b>	

## Features

- Is easier to install compared with other types of mold locking units.
- Requires little slowing down for mold closing. (making the molding cycle more efficient)

## How to Mount

- Install the magnet lock sets with the mold closed. Place them onto the mold's center, and fasten with the supplied bolts.
- Install them so that the magnetic face is in parallel to the parting line.
- Finish the plate surfaces so that the lock's magnets tightly couple together.
- Use MSB Shoulder Bolts if bolt breakage is anticipated. To use a MSB Shoulder Bolt, make sure to create a counterbore on the plate. Finish the counterbore into H7 or so.

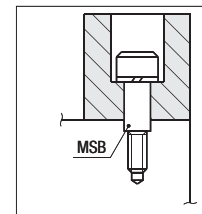

Example

